

RATIO	ETAPAS/STAGES	L	L1
10	1	149	46,2
25	2	158,4	55,6
50	2	158,4	55,6
100	2	158,4	55,6
125	3	167,8	65
250	3	167,8	65
500	3	167,8	65

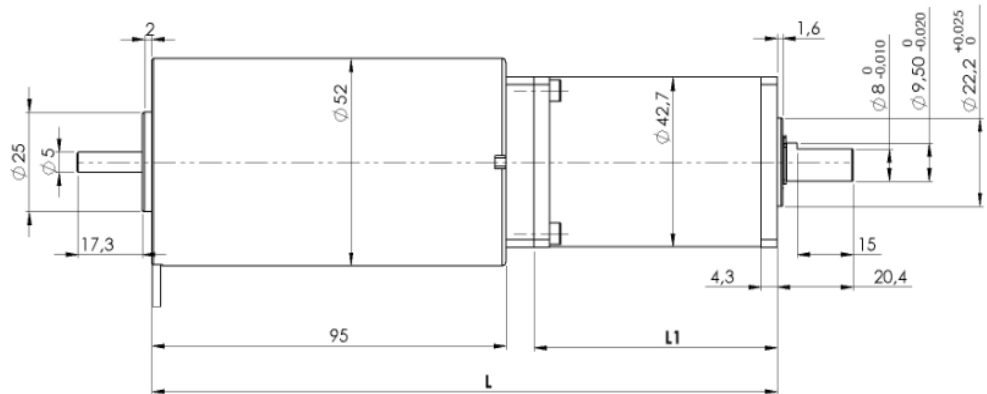
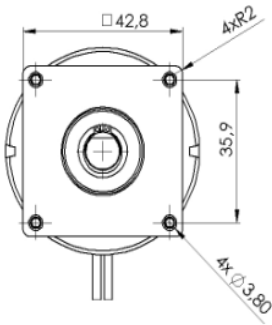

TECHNICAL CHARACTERISTICS

High endurance planetary gearbox for heavy duty continuous workload in any position, at room temperature from -20 to 65°C, with **torque load up to 15 Nm, steady load.**

- **Box.** Steel box. Frontal mounting by four Ø3,8 holes.
- **Gear set.** Hardened steel gears guaranteeing an excellent lifetime.
- **Output shaft.** Ø8 mm. Stainless steel shaft, 20 mm usable length, with a flat
- **Output shaft load:**
 - Axial direction, pull or push 300N.
 - Radial direction, at 5 mm from box 500N.

MOTOR COUPLING:

- **Direct C:** GR53x30 type 12 or 24 V

OPTIONAL:

- Speed regulation with electronic controller

Your special requests are welcome.

			MOTORES DE C.C. - DC MOTORS DUNKER GR53x30					
			GR53x30 12V			GR53x30 24V		
Reducción Ratio i = X:1	Nº Etapas Stages	Eficiencia Efficiency	No load speed Vo (r.p.m.)	Nominal Speed Vn (r.p.m.)	Nominal Torque (N.m)	No load speed Vo (r.p.m.)	Nominal Speed Vn (r.p.m.)	Nominal Torque (N.m)
10	1	0,85	449,00	379,00	0,77	420,00	360,00	0,85
25	2	0,72	179,60	151,60	1,63	168,00	144,00	1,81
50	2	0,72	89,80	75,80	3,25	84,00	72,00	3,61
125	3	0,61	35,92	30,32	6,91	33,60	28,80	7,68
250	3	0,61	17,96	15,16	13,82	16,80	14,40	Ex. Torque max. 15 N·m

NO LOAD SPEED / RATED TORQUE

Motor GR53x30 -12V = 4490 rpm / 0,09 Nm

Motor GR53x30 -24V = 4200 rpm / 0,10 Nm

Ex Exceeds maximal admissible torque

CURVES

GR53x30 12V

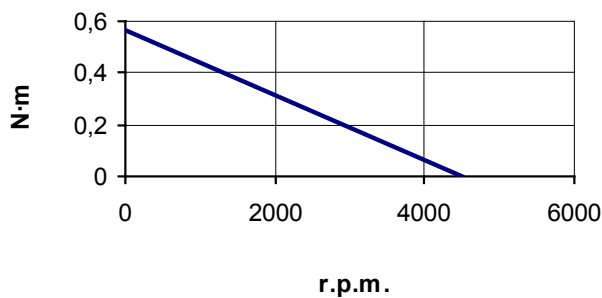

GR53x30 24V

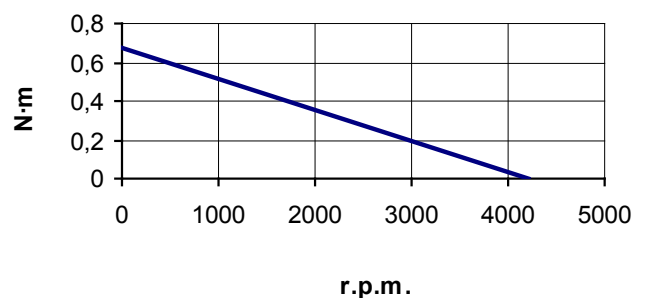

GEARBOX TIPS:

Noise: noise level depends on load symmetry, location (avoid acoustic resonance), and rotation speed; the lower the speed on the input shaft (motor), the lower the noise.